

Plotted: 05/27/25 - 4:08 PM By: kkonius - Product Ver: 25.0  
File: F:\DESPC PROJECTS\5758 UT 20 LLC\25-01613 Pompano Beach FL\Dwg\Entitlements\057582501613S00.dwg, ----> C3.00 PAVING GRADING & DRAINAGE PLAN

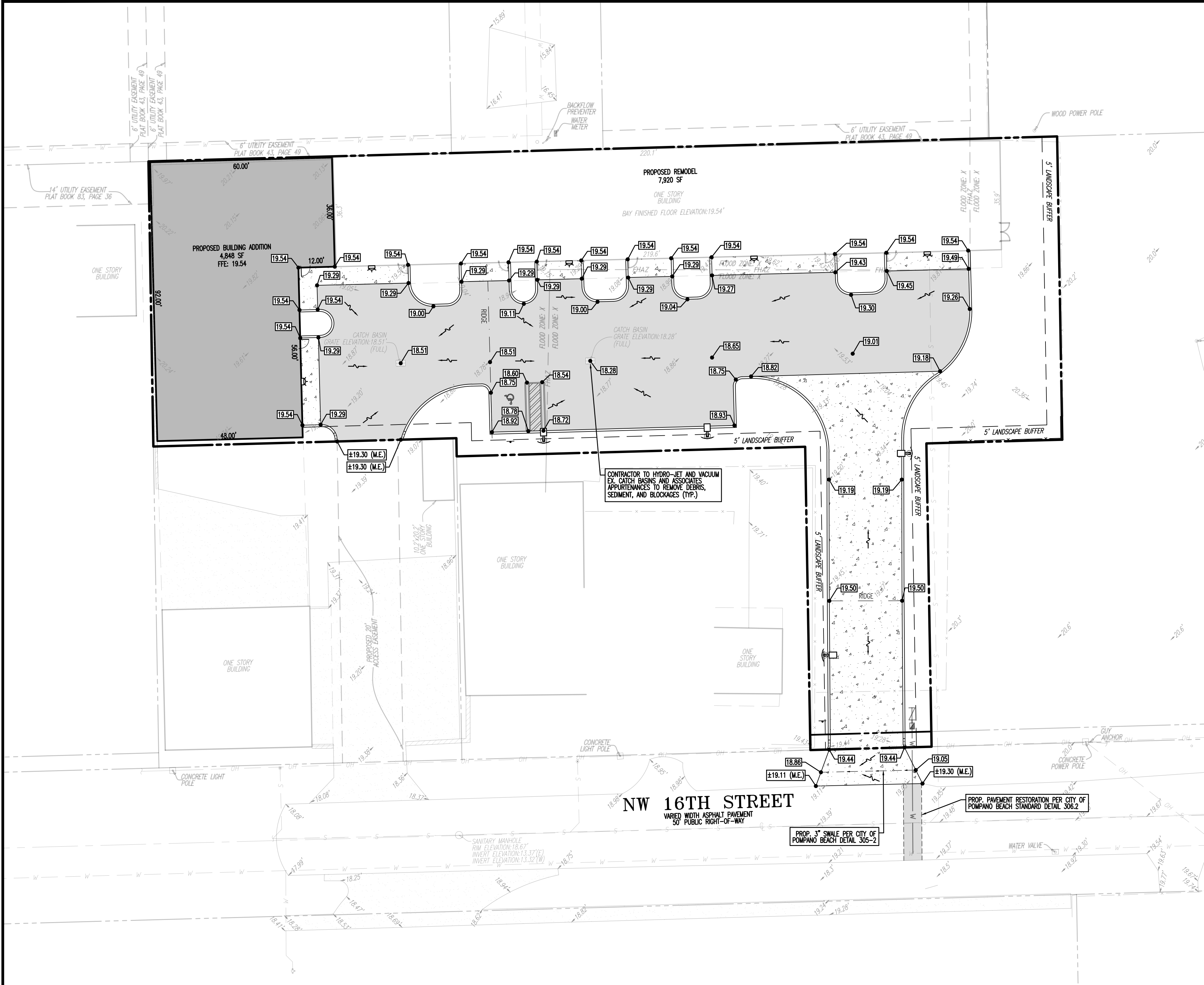

**PAVEMENT LEGEND**

- [Solid Grey Box] = STANDARD DUTY ASPHALTIC CONCRETE PAVEMENT
- [Dotted Grey Box] = STANDARD DUTY CONCRETE PAVEMENT
- [Line with Arrow] = FLOW ARROW
- [Dashed Line] = RIDGE LINE
- [Thin Grey Line] = EXISTING GRADES
- [Thick Grey Line] = PROPOSED GRADES
- [Thick Grey Line with M.E.] = MATCH EXISTING GRADES

- PAVING, GRADING & DRAINAGE NOTES**
- ALL PAVING, CONSTRUCTION, MATERIALS, AND WORKMANSHIP WITHIN PUBLIC RIGHT-OF-WAY SHALL BE IN ACCORDANCE WITH LOCAL, COUNTY OR FDOT REQUIREMENTS.
  - ALL ELEVATIONS ON THE PLANS OR REFERENCED IN THE SPECIFICATIONS ARE BASED ON THE NORTH AMERICAN VERTICAL DATUM OF 1988 (N.A.V.D. '88).
  - THE CROSS SLOPE ON ADA ACCESSIBLE ROUTES SHALL NOT EXCEED 2.0%. THE LONGITUDINAL SLOPE ON ADA ACCESSIBLE ROUTES (NOT INCLUDING RAMPS) SHALL NOT EXCEED 5.0%. THE LONGITUDINAL SLOPE FOR RAMPS SHALL NOT EXCEED 1V:12H (8.3%). ACCESSIBLE PARKING SPACES SHALL NOT EXCEED 2.0% IN ANY DIRECTION (INCLUDING DIAGONAL).
  - CONTRACTOR SHALL CLEAN ALL EXISTING DRAINAGE STRUCTURES AND PIPES UPON COMPLETION OF CONSTRUCTION.
  - PROPOSED ELEVATIONS OF CURB REPRESENT FACE OF CURB OR EDGE OF PAVEMENT ELEVATIONS UNLESS OTHERWISE NOTED.
  - PROPOSED ELEVATIONS IN ALL PERVIOUS AREAS REPRESENT FINISHED TOP OF SOD/GRASS OR ANY OTHER LANDSCAPING MATERIAL.
  - ALL STRIPING IS TO BE PAINTED IN ACCORDANCE WITH FDOT REQUIREMENTS UNLESS OTHERWISE NOTED.
  - CONTRACTOR SHALL ADJUST ALL MANHOLES, VALVE BOXES, ETC. TO PROPOSED GRADE IN VICINITY OF PAVEMENT RECONSTRUCTION AND GRADE CHANGES.
  - GRATES IN PAVED AREAS SHALL BE SET AT GRADE.
  - ALL PAVEMENT MARKING AND STRIPING, EXCLUDING PARKING STALL STRIPING, SHALL BE INSTALLED WITH THERMOPLASTIC MATERIALS. ALSO, PAVER BRICKS OF APPROPRIATE COLOR SHALL BE USED ON PAVER BRICK AREAS IN LIEU OF PAINT OR THERMOPLASTIC MATERIAL.
  - ALL EXISTING AND PROPOSED RIM ELEVATIONS SHALL BE SET TO FINISHED SURFACE GRADE, UNLESS OTHERWISE SPECIFICALLY NOTED ON THE PLAN. THIS SHALL INCLUDE ALL UTILITY, SEWER, WATER AND DRAINAGE STRUCTURES, MANHOLES, INLETS, VAULTS, VALVES AND OTHER APPURTENANCES.

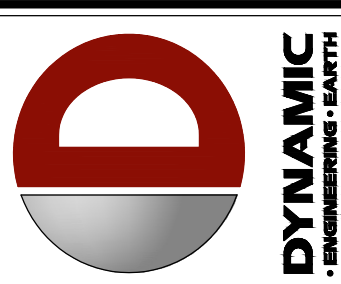
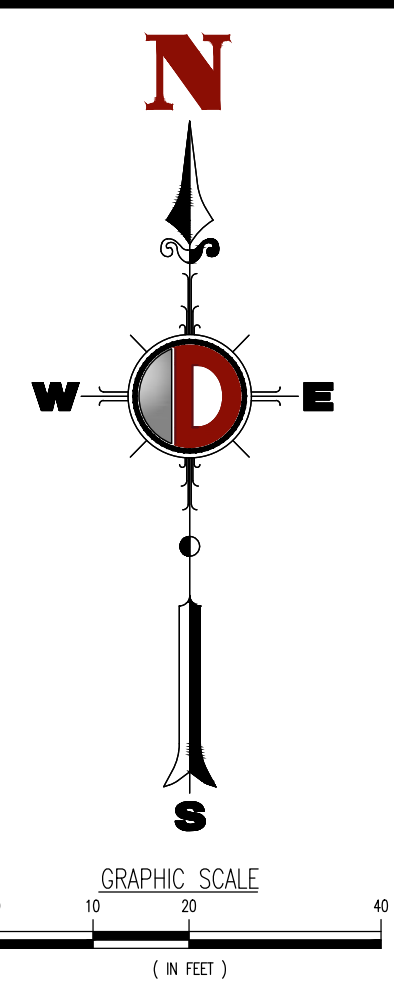

THIS PLAN SET IS FOR PERMITTING PURPOSES ONLY AND MAY NOT BE USED FOR CONSTRUCTION

DESIGNED BY: EC  
CHECKED BY: AP  
DRAWN BY: SRM

PROJECT: **LT 20, LLC PROPOSED WAREHOUSE ADDITION**  
PARCELS: 194-484-22-00-0371  
115 NW 16TH STREET  
POMPANO BEACH, BROWARD COUNTY, FL 33060

**DYNAMIC ENGINEERING**  
LAND DEVELOPMENT CONSULTING • PERMITTING  
GEOTECHNICAL • ENVIRONMENTAL  
TRAFFIC • SURVEY • PLANNING & ZONING

100 NE 5th Avenue  
Suite 82  
Delray Beach, FL 33483  
T: 561.921.8570  
Offices conveniently located throughout the United States:  
New Jersey • Delaware • Florida • Maryland • Pennsylvania • Texas  
Florida Certificate of Authorization No. 32533

www.dynamiccec.com

**ÁNGEL PIÑERO**

PROFESSIONAL ENGINEER  
FLORIDA LICENSE No. 88047  
DATE:

**811**

PROTECT YOURSELF

ALL STATES REQUIRE NOTIFICATION OF EXCAVATORS, DESIGNERS, OR ANY PERSON PREPARING TO DISTURB THE EARTH'S SURFACE OTHERWISE IN ANY STATE

FOR STATE SPECIFIC DIRECT PHONE NUMBERS VISIT: [WWW.CALL811.COM](http://WWW.CALL811.COM)

TITLE: **PAVING, GRADING & DRAINAGE PLAN**

SCALE: (H) AS NOTED  
DATE: 04/15/2025  
PROJECT No: 5758-25-01613

Rev. #:

**DRC**  
**C3.00**

PZ25-12000014

07/02/2025